

Aluminum

ROPP cap MASC cap

Production line

铝旋盖(ROPP)
塑料防盗环铝旋
盖(MASC)

生产线



SACMI

Ropp caps

铝旋盖(ROPP)

Roll On Pilfer Proof Caps

铝制旋开式防盗瓶盖(ROPP)

SACMI SKILLS AND COMPETENCE

萨克米专业领域和竞争优势

Aluminum caps are used to close glass bottles filled with mineral and natural waters, non-alcoholic and alcoholic beverages, pharmaceutical and technical contents or juices.

Sacmi machines are engineered to produce ROPP (roll-on pilfer proof) caps and RO that are cost-effective, provide an effective seal (and barrier), are compatible with contents, easily opened by the consumer, are often re-closable and comply with product, packaging and environmental laws and regulations.

ROPP: Roll on pilfer proof
RO: Roll on

铝盖应用于玻璃容器，适用于包括矿泉水、天然水、非酒精及酒精类饮料、保健品及果汁类产品。

萨克米铝旋盖生产设备适用于生产ROPP和RO铝盖，除高效和高产的优点之外，其密封性能优越，与容器匹配完美，易开易旋，并遵守与产品、包装、环境相关的法律和规章制度。

ROPP: 铝制旋开式防盗瓶盖
RO: 铝制旋开式瓶盖

VERSATILITY

they fit glass/PET necks, for both returnable and non-returnable bottles

PERFORMANCE

PVC-free liner provides optimum sealing

ALUMINUM

does not rust, and can be recycled forever

SUSTAINABILITY

TE band remains with the closure after opening, favouring bottle re-use

USER FRIENDLINESS

easy and safe opening and re-sealing

多样

适用于玻璃/PET容器，包括可回收及不可回收容器。

性能

采用非PVC内垫以利于瓶盖密封

铝制

不易生锈，可回收再利用。

可持续性

瓶盖开启后防盗环与瓶盖相连，易于容器再次使用。

简单易开

易开易旋，安全密封。

ALUMINUM SHELL

铝制盖壳

PVC FREE LINER

非PVC内垫



Ropp Caps
ROPP瓶盖

DIFFERENT PRODUCT STANDARDS

Roll-on pilfer proof cap with anti-tamper band and liner. Suitable for water, beer, wine, soft drinks and energy drinks.

盖型分类

铝制旋开式防盗瓶盖（含内垫及防盗环）适用于水、啤酒、葡萄酒、软饮及功能性饮料产品。

28X15.5 MM

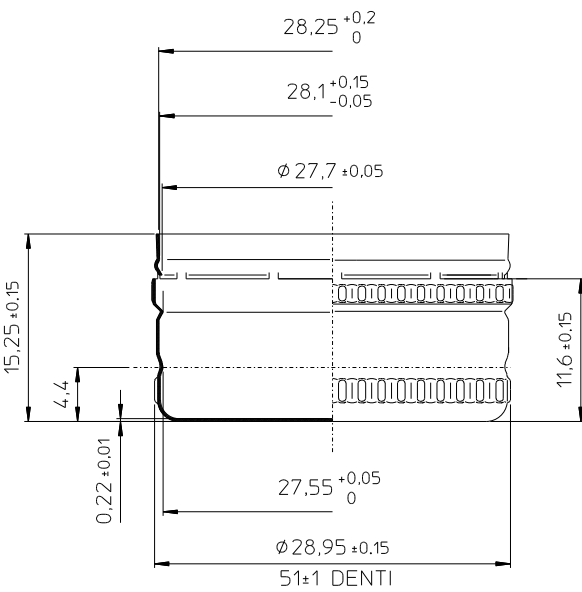

31.5X18 MM

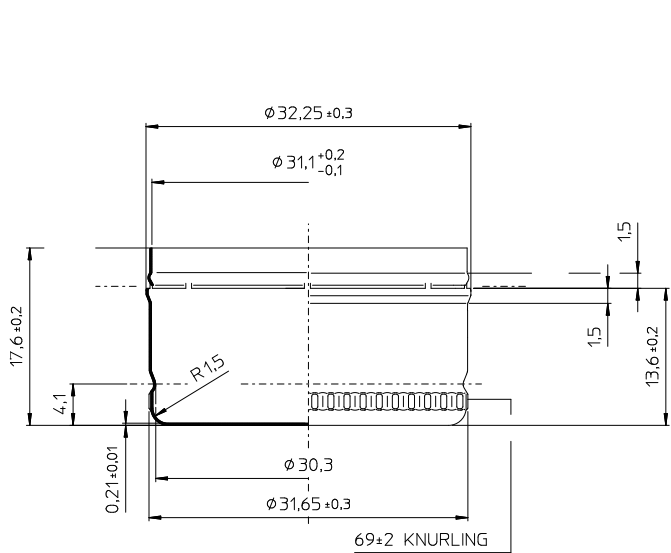

28X18 MM

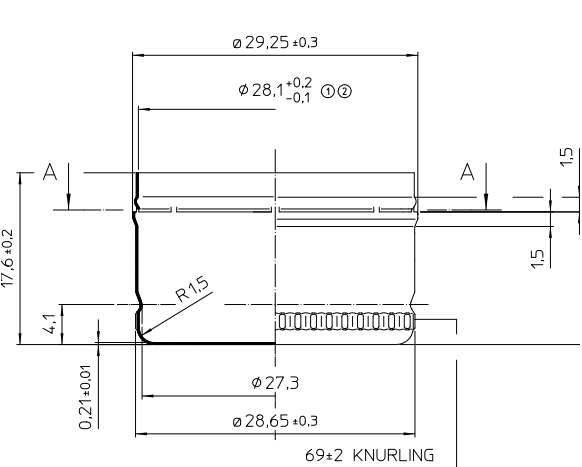

38X18 MM

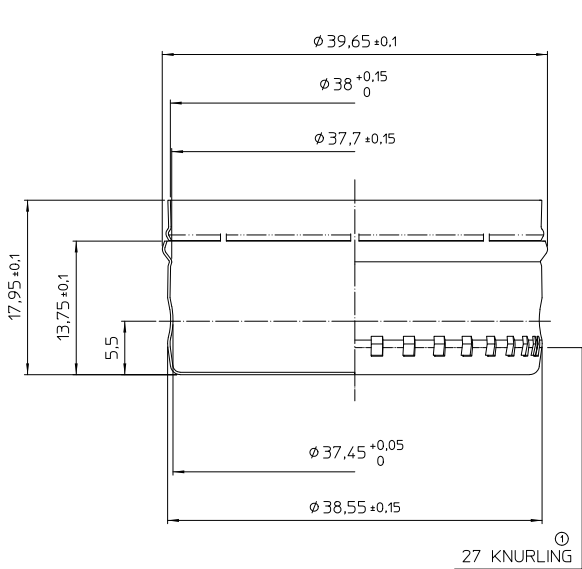

UP TO 2,500 PCS/MIN
产量高达每分钟2,500个瓶盖

PTV 119

Aluminum cap press
铝盖冲压设备

CVS 3000 inspection system

Easy, intuitive, reliable, net workable

CVS 3000 视像检测系统
精准、高效、可靠、灵活

PMV 136

In-shell lining machines for aluminum caps
铝盖壳内加垫设备

BTV 900

Aluminum cap knurling machine
铝盖滚花切环设备

CHS 200

An inspection and sorting machine for short aluminium caps.
视像检测设备用于铝制矮盖。

Aluminum ROPP cap production line*

铝旋盖生产线

	PTV 119	BTV 900	PMV 136
Elec. power average absorbed - kW 平均吸收功率 – kW	12	4,5	24
Machine total weight - kg / 设备总重量 – kg	12000	600	6700
Number of dies / 模具数量	19	9	36

*The same production line is suitable for RO caps
* 相同配置亦适用于生产RO瓶盖。

Masc caps

铝旋盖(MASC)

Multicomponent Aluminum SACMI Caps

塑料防盗环铝旋盖(MASC)

MULTIMATERIAL SOLUTIONS

复合材料铝旋盖解决方案

Aluminum screw caps are used to close glass bottles containing mineral and natural waters, non-alcoholic and alcoholic beverages, pharmaceutical and technical contents or juices. They maximize protection for both the product and the consumer. A plastic tamper evidence band ensures "original product" security and allows trouble-free opening and reclosing; this special-format cap also ensures easier, safer handling. From a manufacturing view, production processes are smooth and efficient.

铝旋盖应用于玻璃容器, 适用于包括矿泉水、天然水、非酒精及酒精类饮料、保健品及果汁类产品。采用塑料防盗环为产品口感提供切实保障。其独特盖型安全可靠, 易开易旋。从制造商角度出发, 生产加工高效灵活, 瓶盖表现优异, 为当今市场提供全新包装解决方案。

TAMPER-EVIDENT SECURITY

- The plastic tamper-evident band separates into 3 parts on opening
- Tamper-evident band stays attached to closure after opening
- injury-free

A PERFECT SEAL

- Excellent sealing performance thanks to PVC-free liner
- Easy, safe opening and re-sealing thanks to smooth aluminum closure edge
- Ideal for both returnable and non-returnable bottles

ENGINEERED FOR QUALITY

- Bottle is extremely easy to carry, open and re-seal
- Excellent removal torque consistency

PREMIUM SOLUTION FOR YOUR MARKET

- Unmatched standards in terms of practicality, process and consumer convenience.

防盗环安全可靠

- 瓶盖开启时, 塑料防盗环断裂为三个部分
- 瓶盖开启后, 塑料防盗环与瓶盖仍然相连
- 安全可靠

完美密封

- 非PVC内垫使密封性能发挥到最大
- 铝盖边缘光滑平整, 易开易旋。
- 适用于可回收或不可回收容器

产品质量

- 容器开启时安全可靠, 易开易旋, 同时, 也有利于再次密封。
- 开启扭矩表现卓越

当代市场的优选方案

- 萨克米金属瓶盖解决方案以其实用、精确、便利等特点赢得市场赞誉。

PVC FREE LINER
非PVC内垫



TE BAND
防盗环

ALUMINUM SHELL
铝制盖壳

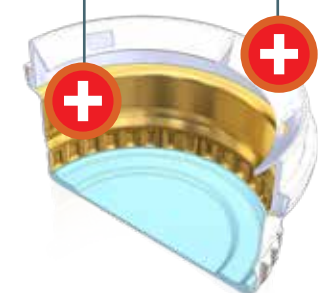

MASC Caps

塑料防盗环铝旋盖

Making bottles quick, easy and convenient to carry, open and reseal, screw caps with plastic te band caps ensure consistent removal torques while allowing for multicolor printing. The resulting high-quality appearance enhances both brand image and turnover, with in-the-cap printing making the aluminum closure ideal for promotional campaigns.

TAMPER EVIDENCE SECURITY

- Plastic tamper evidence band separates into 3 segments on opening
- Tamper evidence band remains with the closure after opening

PERFECT SEALING PERFORMANCE

- PVC-free liner provides optimum sealing performance
- Smooth aluminum closure edge for easy and safe opening and resealing

PRODUCT SPECIFICATIONS

- 28 mm aluminum roll-on closure, with plastic tamper evidence band
- Fits glass neck finishes / PET necks
- For returnable and non-returnable bottles
- For cold and hot-fill, pasteurized and carbonated beverages
- Can be applied using standard roll-on application machinery

瓶盖性能优异, 易于开启和再次完美密封。铝旋盖采用塑料防盗环确保瓶盖开启扭矩在界定和可控范围之内。塑料防盗环更可提供多色选择。高质量的外观可有效加强品牌形象以及产量增长。同时盖内涂印技术更使得铝盖有力助推市场营销活动。

塑料防盗环

- 瓶盖开启时, 塑料防盗环断裂为三个部分
- 瓶盖开启后, 塑料防盗环与瓶盖仍然相连

完美密封性能

- 非PVC内垫使密封性能发挥到最大
- 铝盖边缘光洁平滑, 开启时安全, 也有利于再次密封。

设备特点

- 28mm塑料防盗环铝旋盖
- 适用于玻璃/ PET瓶口
- 适用于可回收和不可回收容器
- 适用于冷灌装、热灌装、巴氏杀菌和碳酸饮料
- 适用于标准旋开铝盖设备

28,7X17,5 MM

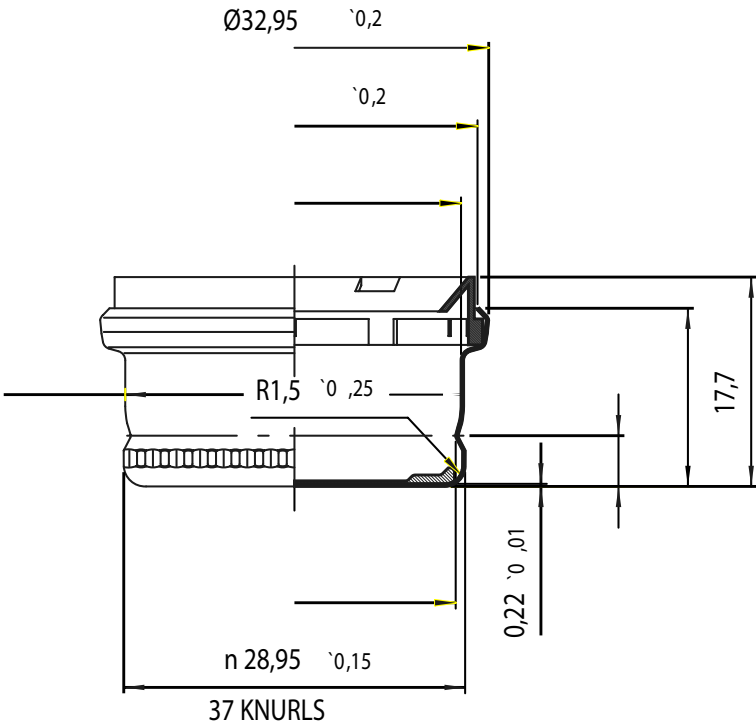

UP TO 1,200 PCS/MIN

产量高达每分钟1,200个瓶盖

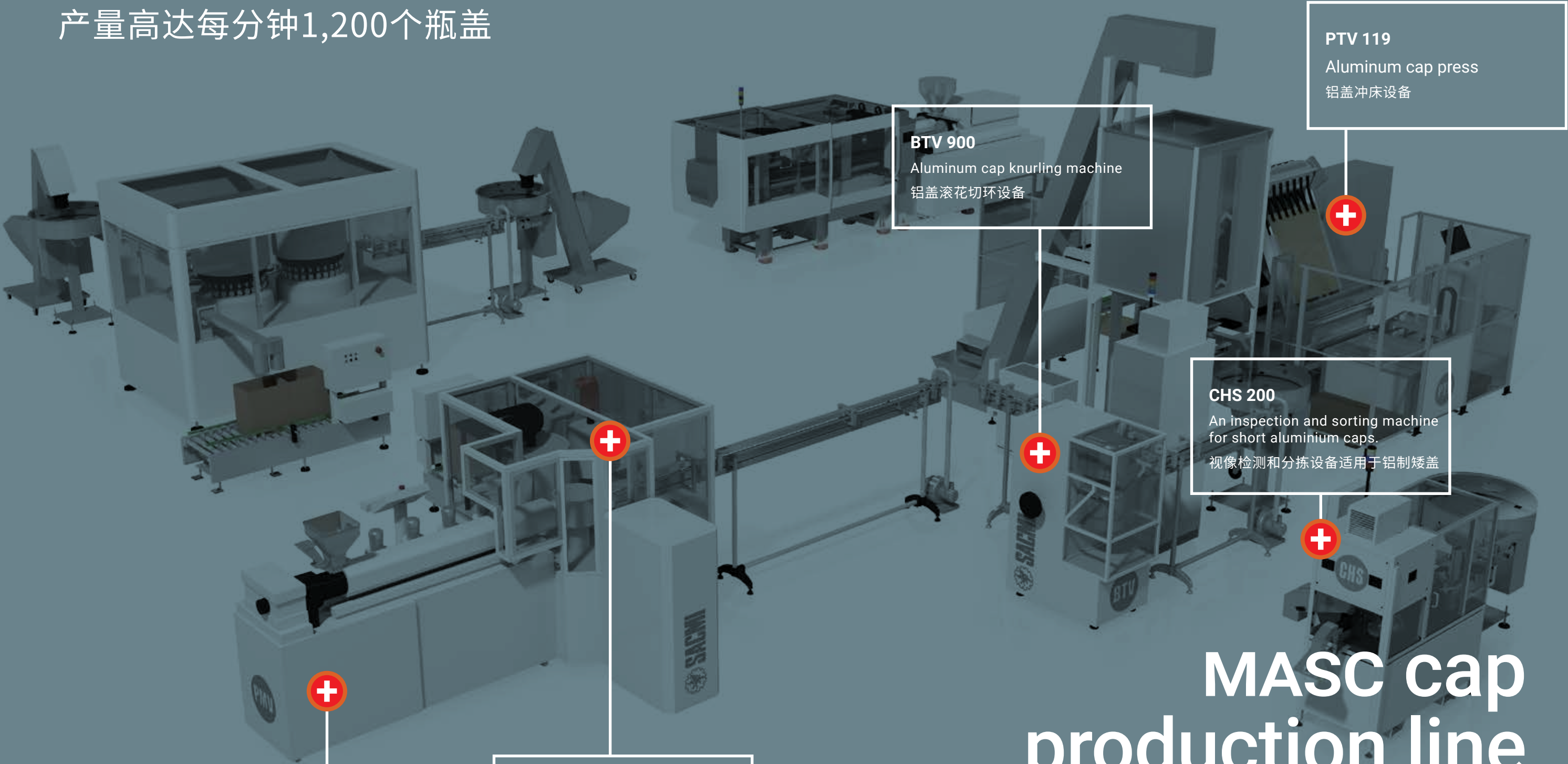

BTU 900
Aluminum cap knurling machine
铝盖滚花切环设备

PTV 119
Aluminum cap press
铝盖冲床设备

CHS 200
An inspection and sorting machine
for short aluminium caps.
视像检测和分拣设备适用于铝制矮盖

CVS 3000 inspection system
Easy, intuitive, reliable, net
workable
CVS 3000 视像检测系统
精准、高效、可靠、灵活

PMV 136
In-shell lining machines for
aluminum caps
铝盖壳内加垫设备

MASC cap production line

塑料防盗环铝旋盖
(MASC)生产线

PTV 119

PRESS FOR ALLUMINUM CAPS
铝盖冲床设备

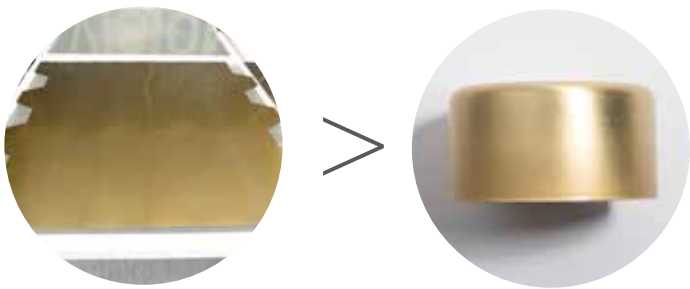

Double-action mechanical press for the manufacture of alu-caps, suitable for use with multi-punch die. The production process consists of picking the sheets, blanking them and moulding the caps. Press for the manufacture of alu-caps using pre-painted sheets.

The machine is a more advanced version of the PTV019 currently in production.

- Solutions that improve product quality and workplace health (thanks to a sheet metal feed system that is independent from the press, noise and vibration have been cut to below 3.5 dB)
- Guaranteed decoration alignment thanks

双头机械冲床适用于使用多头冲模来生产铝盖。加工过程包括提取金属板料、压紧板料并按要求冲压成所需的瓶盖形状。铝盖生产采用预涂层板材。

PTV119是现有冲床PTV019的升级版。

- 改善产品质量和优化生产环境的解决方案（由于采用了冲床独立的金属板材进料系统，噪音和振动已降低到3.5分贝以下）。
- 可与CVS3000视像检测设备连线，为产品质量保驾护航。
- 冲床和板材给料系统完全分离，防止冲床部



PTV 119

- to integration with the CVS 3000 inspection system and the electronically controlled sheet feed system
- The press and sheet loading system are completely separated, preventing transfer of residual vibration from the press to the load system
- Flywheel contained inside the main machine structure, guaranteeing reduced overall dimensions
- Low positioning of main shaft to ensure a centre of gravity as close as possible to the ground
- High-rigidity structure designed to reduce vibration
- Easy access to the upper and inner area for easier maintenance

THE KEY CHARACTERISTICS OF THE MACHINE ARE MAINTENANCE OF CURRENT OUTPUT RATES WITH THE CVS:

- Pallets can be positioned with ease
- Sheet positioning adjustment can be performed in automatic mode. The CVS 3000 is available (optional) to perform this adjustment in feedback loop mode.
- Electronically controlled sheet feed
- Safety guards with improved access and ergonomics
- Mould compatible with current one

- 分的振动影响给料系统 可与CVS3000视像检测设备连线,为产品质量保驾护航。
- 飞轮位于主机框架内,减少设备总体尺寸。
- 主轴位置低,确保重心尽可能靠近地面。
- 高刚性结构设计减少设备振动。
- 工人易于进入设备的上部和内部,方便维修。

与CVS视像检测设备连线、稳定保持现有产量,主要特点:

- 托盘定位更方便。
- 全自动调节铝板并精确定位 全自动调节铝板并精确定位。
- 铝板进板通过电气控制。
- 安全护栏,符合人体工程学。
- 与现有模具完美兼容。

STT027B MOULD

Functional improvements: ejector movements warranted by a mechanical limit

Improvements for the reduction of the wear: moulding die area modified with a new coupling steel/sintetic bushing

improved forming punch nod guide system bushes

Interchangeability of tool parts:

- Punch with cutting carbide
- Shearing matrix carbide
- Forming matrix
- Press-sheet
- Column’s guides
- Ball cages

Improvements for maintentance interventions. Forming punch rods: the whole group can be easily dismpunted from the top

STT027B 模具

功能改进:剔除运动由机械限位调控

减少磨损:模切区采用新型连接钢或合成衬套

改进成型冲头导向系统衬套

工具零件互换性:

- 碳合金切料
- 矩阵硬质合金修剪
- 成型矩阵
- 冲板
- 导柱
- 滚珠轴承罩

改进维修保养方式。成型冲头杆:整个组可以很容易地从顶部展开。

TECHNICAL FEATURES
技术参数

PTV 119 - 150 STROKES / minute MAX(*) / PTV119冲床设备最大效率为每分钟150冲程(*)				
Cap Dimension (mm) / 瓶盖尺寸 (毫米)	28x15	28x18	38x18	Masc Cap
Blank Diameter (mm) / 盖坯直径 (毫米)	51	53,8	66	52,9
Tools / 模具数	19	19	15	19

(*) Max mechanical speed, but may vary depending on format (*) 最大理论速度。不同盖型，其生产速度略有不同。

BTV 900

ALUMINUM CAP KNURLING MACHINE
FOR ALUMINUM CAPS
铝盖滚花切环设备

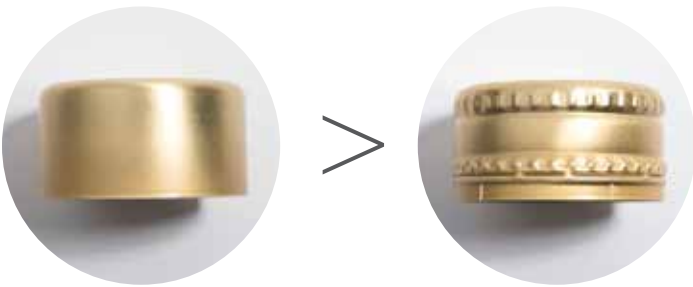

Machine with vertical turret to slit the tamper evident band and knurl the aluminum cap edges. The BTV900 consists of 9 rotary heads which “by working against fixed tools” knurl and horizontally/vertically slit the cap as per requested specifications.

The machine integrates smoothly with the rest of the line in terms of both output capacity and automation.

BTV900适用于切割铝盖防盗环以及压制滚花，配有9个旋转头搭配固定模具来根据盖型要求切割滚花和防盗环。

铝盖滚花切环设备与现有生产线完美兼容，全自动运行，确保产量。



TECHNICAL FEATURES 技术参数

Version / 设备名称	knurling / 铝盖滚花切环设备
Cap dial - mm / 瓶盖直径—毫米	26-43
N. of dies / 模具数量	9
Max prod. capacity pcs/min / 最大生产效率 (个/每分钟)	1300
Elec. power average absorbed - kW (50 hz) / 平均吸收电功率—千瓦 (50赫兹)	4,5
Compressed air consump. 0.55 MPa - NI/min / 压缩空气量 0.55Mpa—NI/分钟	9000
Dimension mm / 设备面积尺寸 - 毫米	1000x1000
Weight kg / 重量 - 千克	600

PMV 136

IN-SHELL LINING MACHINES
FOR ROPP AND MASC CAPS

ROPP铝旋盖和
MASC塑料防盗环铝旋盖的壳内加垫设备

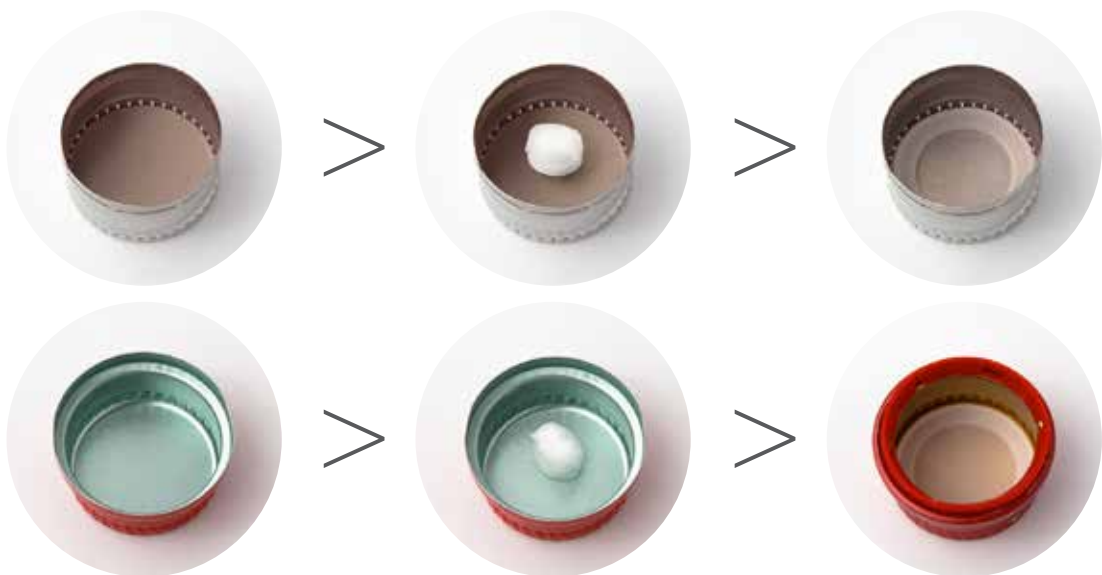

Automatic lining machines designed to extrude pellet-form material (e.g. PVC-free, PE, EVA), cut it into single doses, insert them into aluminum screw caps and mould the liner according to a clearly defined profile. Machine productivity is strongly influenced by the material type and the weight and profile of the liner.

In-shell casting technology allows liners to be shaped to maximise closure performance and minimise the weight of the used compound.

全自动加垫设备适用于热塑材料（如非PVC料，PE料和EVA），通过将熔融后挤出的原料切割成单个球状粒料，并投入盖壳后最终模压成型。设备产能与所使用的原料、内垫重量以及形状密切相关。

壳内加垫工艺使瓶盖发挥最大性能，并有效减轻瓶盖的重量。



TECHNICAL FEATURES 技术参数

Version / 版本	inshell / 壳内
Cap dial - mm / 瓶盖尺寸—毫米	26-33
N. of punches / 冲头数	36
Max prod. capacity pcs/min / 最大生产效率(个/每分钟)	1600
Elec. power average absorbed - kW (50 hz) / 平均吸收电功率—千瓦(50赫兹)	24
Compressed air consump. 0.55 MPa - NI/min / 压缩空气量0.55Mpa — NI/分钟	900
Dimension mm / 设备面积尺寸 - 毫米	4000x4000
Weight kg / 重量 - 千克	6700

PMV 136

The machine is equipped with cap outfeed conveyor belt predisposed for the installation of a CVS3000 vision system.

THE MACHINE IS EQUIPPED WITH:

- Extruder with 45 mm screw, equipped with inverter-controlled AC motor to feed the molten material. Screw temperature and rpm are managed by the control system
- Molten material by-pass valve to clean the extruder, to start and stop the machine
- Low frequency magnetic induction unit to heat the caps, equipped with cooling system
- Cooling system which allows independent temperature control of moulds and accessories
- CVS3000 vision system to control quality of the liner
- Optional additional camera to check the decoration
- Pneumatically operated faulty cap reject device
- Outgoing cap counter with flow diverter for boxing
- Operator interface via PC

设备的瓶盖出口传送皮带上预留位置，用于 CVS3000视像检测系统的安装。

设备包括：

- 挤出机配有45毫米直径螺杆，AC马达和变频器控制，适用于进料。温控和螺杆数量由控制系统控制。
- 熔料旁路阀适用于清洗挤出机，可以在设备开启和停止时启动。
- 低频磁性感应装置用于加热瓶盖，配有冷却系统。
- 冷却系统允许模具和辅件温度的独立控制。
- 配有摄像机的控制系统检测内垫。
- 带摄像机(可备选CVS视像检测系统)的控制系统安装转盘检测平面印刷质量。
- 剔除装置气动剔除瓶盖次品。
- 带分流器的出盖计数器用于装箱。
- PC操作界面。

PMV 120

ALU-CAP LINING MACHINE
铝盖加垫设备

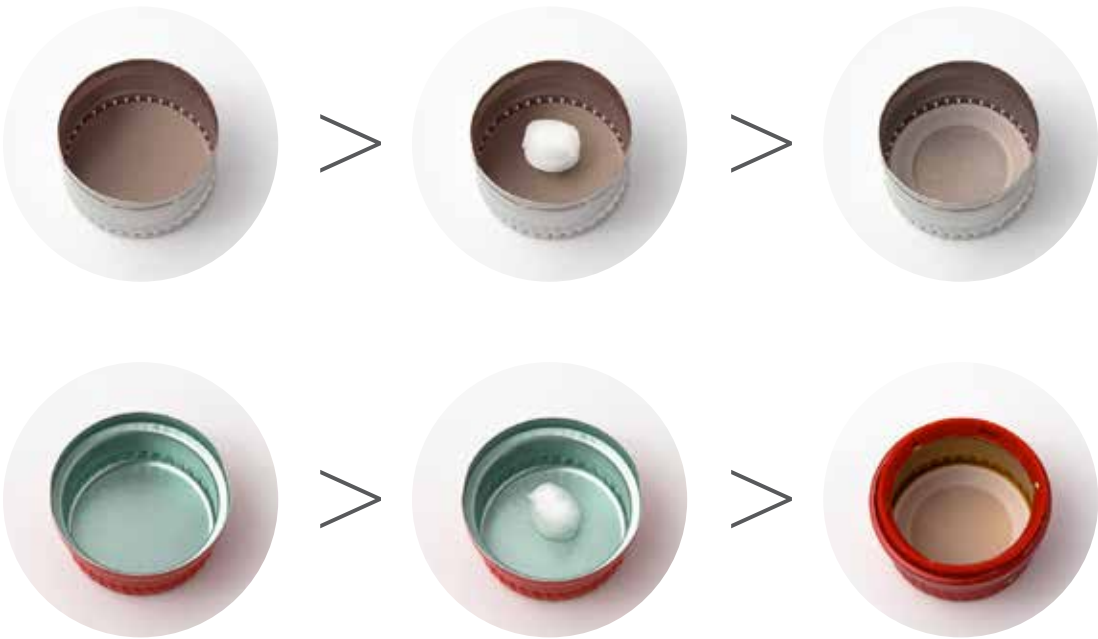

Automatic lining machine suitable for extruding (PVC-free) pellet material, cutting the material into individual doses, inserting the dose inside the aluminium screw cap and moulding the liner according to a specifically designed profile. Machine productivity is strongly influenced by the type of material used, the weight and the profile of the liner.

全自动加垫设备适用于热塑材料(如非PVC料, PE料和EVA), 通过将熔融后挤出的原料切割成单个球状粒料, 并投入盖壳后最终模压成型。设备产能与所使用的原料、内垫重量以及形状密切相关。

PMV 120

THE MACHINE IS EQUIPPED WITH:

- Extruder with 35 mm screw, equipped with inverter-controlled AC motor to feed the molten material. Screw temperature and rpm are managed by the control system
- Molten material by-pass valve to clean the extruder, to start and stop the machine
- Low frequency magnetic induction unit to heat the caps, equipped with cooling system
- Cooling system which allows independent temperature control of moulds and accessories
- CVS3000 vision system control quality of the liner
- Optional additional camera to check the lithography
- Cap outfeed conveyor belt predisposed for the installation of a CVS3000 vision system
- Pneumatically operated faulty cap reject device
- Outgoing cap counter with flow diverter for boxing
- Automation and Beckhoff control system
- Operator interface via PC

设备包括：

- 挤出机配有35毫米直径螺杆, AC马达和变频器控制, 适用于进料。温控和螺杆数量由控制系统控制。
- 熔料旁路阀适用于清洗挤出机, 可以在设备开启和停止时启动。
- 低频磁性感应装置用于加热瓶盖, 配有冷却系统。
- 冷却系统允许模具和辅件温度的独立控制。
- 配有摄像机的控制系统检测内垫。
- 带摄像机(可备选CVS视像检测系统)的控制系统安装转盘检测平面印刷质量。
- 设备的瓶盖出口传送皮带上预留位置, 用于CVS3000视像检测系统的安装。
- 剔除装置气动剔除瓶盖次品。
- 带分流器的出盖计数器用于装箱。
- Beckhoff 自动控制系统。
- PC操作界面。



TECHNICAL FEATURES
技术参数

Cap diameter / 瓶盖直径	26 - 38 mm
Cap height / 瓶盖高度	15 - 24 mm
Cap material / 瓶盖材料	Aluminum / 铝质
Requested output rate / 需求生产率	up to 1000 caps / 最快1000个瓶盖
N° of punches / 冲头数量	20
Type of plastic to be processed / 待加工的塑料类型	PVC - free / 非PVC
Maximum PVC-free liner weight / 非PVC内垫最大重量	0.3 g
Cap interior quality control type (optional) / 瓶盖内部质量控制(备选)	Video camera (CVS) / 视像检测 (CVS)
Cap outer bottom quality control type (optional) / 瓶盖外底部质量控制(备选)	Video camera (CVS) / 视像检测 (CVS)

INSPECTION SYSTEMS 视像检测设备



DEFECTS IN THE SIDEWALL (THROUGH PERIPHERAL LENS):

- Contaminations
- Black specks
- Dents
- Broken bands
- Indicative measurement of the diameter

侧壁缺陷(外围镜头):

- 污染
- 黑斑
- 压痕
- 破损
- 直径尺寸

DEFECTS IN THE LINER:

- Presence
- Flashes of material in the profile
- Voids of material in the profile
- Contaminations
- Black specks
- Bubbles

内垫缺陷:

- 内垫是否就位
- 原料闪光
- 孔洞
- 污染
- 黑斑
- 气泡

DEFECTS IN THE ARTWORK:

- Presence
- Registration errors
- Off-centre
- Missed colour planes
- Wrong colours
- Colour variations (ΔE)
- Wrong artwork
- Scratches
- Dents
- Voids in the artwork
- Contamination
- Fish-eyes
- Smears
- Smudges

印刷图案缺陷:

- 印刷图案是否存在
- 配准误差
- 对中偏离
- 色块错误
- 颜色错误
- 颜色偏差(ΔE)
- 图案错误
- 划痕
- 压痕
- 图案孔洞
- 污染
- 鱼眼
- 油剂
- 污迹

DEFECTS IN THE SHELL:

- Ovalization
- Deformations
- Voids
- Chipped
- Holes
- Wrinkles
- Indicative measurement of the diameter

外壳缺陷:

- 椭圆化
- 变形
- 孔洞
- 缺口
- 小孔
- 褶皱
- 直径尺寸测量



CVS 3000

INSPECTION SYSTEM

视像检测设备

Every stage of cap manufacturing is controlled by CVS3000 to ensure the highest quality level and process monitoring.

瓶盖生产的每一个环节都由CVS3000检测系统把控以确保高质量全程监督。

From the lined shell to the terminated caps, every component is carefully inspected with high-resolution cameras and the newer vision technologies.

从内垫到最终成型的瓶盖, 每一个部分都由高精度摄像头严格检测。

Thanks to a graphical and user-friendly interface, based on Windows Embedded, and available in several languages, the operator can easily interact with the equipment.

易操作多语言的界面使得操作者更好掌控设备。

A Self-learning procedure helps to find quickly the correct inspection parameters, without specific skills.

系统的自我学习功能使其能够快速获得检测参数。

Moreover, CVS3000 can provide to the Quality Control and Maintenance Depts. Statistical information about the monitored production, giving real-time information such as:

CVS3000可提供质量控制及维护的数据信息, 并实时分享:

TECHNICAL FEATURES
技术特点

CVS3000 IN PMV136 MACHINE
CVS3000适用于加垫设备PMV136

Calculation unit 计算单元	Industrial PC equipped with i7 processor 配备i7 处理器的电脑
Operating System 操作系统	Windows Embedded 64 bit Windows 嵌入式64位版
Inspection of the liner and shell 内垫及外壳检测	High resolution monochrome camera 高清黑白摄像头 LED illuminator / LED光源
Inspection of the artwork 印刷面图案检测	High resolution colour camera / 高清摄像头 LED illuminator / LED光源
Ejection device for liner/shell defects 内垫/外壳缺陷剔除装置	Pneumatic solenoid valve 气动伺服阀
Ejection device for artwork defects 印刷面图案缺陷剔除装置	Pneumatic solenoid valve 气动伺服阀
FRS (Failsafe Rejection System) 故障安全排除系统	Part presence sensor 感应装置 Pneumatic solenoid valve 气动伺服阀
Tracking device 追踪装置	Encoder 编码器

CVS3000 IN PMV 120 MACHINE
CVS3000用于加垫设备PMV120

Calculation unit 计算单元	Industrial PC equipped with i7 processor 配备i7 处理器的电脑
Operating System 操作系统	Windows Embedded 64 bit Windows 嵌入式64位版
Inspection of the liner and shell 内垫及外壳检测	High resolution monochrome camera 高清黑白摄像头 LED illuminator / LED光源
Inspection of the artwork 印刷面图案检测	High resolution colour camera / 高清摄像头 LED illuminator / LED光源
Inspection of the sidewall 侧壁检测	4 high resolution colour camera / 4个高精度摄像头 LED illuminator / LED光源 CVS 360-3D inspection software / CVS360-3D检测软件
Ejection of defects 缺陷品剔除	Pneumatic solenoid valve 气动伺服阀
FRS (Failsafe Rejection System) 故障安全排除系统	Part presence sensor 感应装置 Pneumatic solenoid valve 气动伺服阀
Tracking device 追踪装置	Encoder 编码器



CHS 200

AN INSPECTION AND SORTING MACHINE
FOR SHORT ALUMINIUM CAPS

视像检测设备适用于检测及分拣铝盖

It can be easily integrated after a lining machine or assembly machine as well as off-line to reprocess HFI batches.

CHS200 can install up to 7 cameras to control both functional and public decorated side (bottom and sidewall) at a speed up to 3,000 caps/min.

Thanks to the innovative CVS360-3D module, the CHS200 can precisely reconstruct 3D objects as 2D images, eliminating any distortion stem from perspective, lens, shape of the cap or the reflectiveness of its surface.

CHS200可与加垫设备整合, 或者离线安装, 对高频感应批次再处理。

CHS200共可安装7个摄像头用以检测印刷面(底部及侧壁), 检测速度最高3,000瓶盖/分钟。

CVS360-3D的应用使得CHS200可以将3D物体重建为2D图像, 消除因角度、镜头、瓶盖形状或者表面反光带来的变形。



TECHNICAL FEATURES 技术特点

Lighting equipment / 照相设备	white light, LED / LED白光
Cameras / 镜头	Colour camera for the inspection of public decorated side / 彩色镜头用以检测印刷面。 Monochrome/colour camera for the inspection of the functional side / 黑白/彩色镜头用以检测其它表面缺陷。
CPU: / 中央处理器	Intel i7 / 英特尔i7
Operating System / 操作系统	Windows 7 Embedded 64 bit edition / Windows 7嵌入式64位版
Inspection software / 检测软件	CVS3000 2.0 64 bit or higher, CVS360-3D / CVS3000 2.0 64位版或者更高配置的CVS360-3D
Maximum speed / 最大速度	up to 3,000 pcs/min / 3,000瓶盖/分钟
FRS / 故障安全排除系统	Fail safe rejection system / 故障安全排除系统
Ready for Industry 4.0 / 适用于工业4.0	
Options / 可选项	Peripheral lens to inspect decorated bottom and sidewall / 检测瓶盖底部及侧壁
CVS360-3D module for a precise inspection of the sidewall / CVS360-3D用于侧壁精确检测	



“INTEL is a registered trademark of Intel Corporation or other companies controlled by Intel in the United States and/or in other Countries. The trademark is subject to intellectual property's legislation, and SACMI's use is in compliance with the applicable framework. INTEL trademark is in this catalogue only for descriptive and explanatory purposes, in a truthful and non-misleading manner, and without the aim of promoting SACMI's products.”

“MICROSOFT is a registered trademark of Microsoft Corporation, registered in the United States and/or in other Countries. The trademark is subject to intellectual property's legislation, and SACMI's use is in compliance with the applicable framework. MICROSOFT trademark is in this catalogue only for descriptive and explanatory purposes, in a truthful and non-misleading manner, and without the aim of promoting SACMI's products.”

“WINDOWS is a registered trademark of Microsoft Corporation. The trademark is subject to intellectual property's legislation, and SACMI's use is in compliance with the applicable framework. WINDOWS trademark is in this catalogue only for descriptive and explanatory purposes, in a truthful and non-misleading manner, and without the aim of promoting SACMI's products.”

“Intel Core i7 is a registered trademark of Intel Corporation or to other companies controlled by Intel in the United States and/or in other Countries. The trademark is subject to intellectual property's legislation, and SACMI's use is in compliance with the applicable framework. Intel Core i7 trademark is in this catalogue only for descriptive and explanatory purposes, in a truthful and non-misleading manner, and without the aim of promoting SACMI's products.”

“INTEL 是 Intel Corporation 或在美国和/或其他国家/地区受其管控的其他公司的注册商标。该商标受知识产权法律约束, SACMI 对该商标的使用符合适用的框架。INTEL 商标仅具有描述性和解释性作用, 以真实且无误导的方式出现在本目录中, 并且不具有推广 SACMI 产品的目的。”

“MICROSOFT 是 Microsoft Corporation 或在美国和/或其他国家/地区受其管控的其他公司的注册商标。该商标受知识产权法律约束, SACMI 对该商标的使用符合适用的框架。MICROSOFT 商标仅具有描述性和解释性作用, 以真实且无误导的方式出现在本目录中, 并且不具有推广 SACMI 产品的目的。”

“WINDOWS 是 Microsoft Corporation 的注册商标。该商标受知识产权法律约束, SACMI 对该商标的使用符合适用的框架。WINDOWS 商标仅具有描述性和解释性作用, 以真实且无误导的方式出现在本目录中, 并且不具有推广 SACMI 产品的目的。”

“Intel Core i7 是 Intel Corporation 或在美国和/或其他国家/地区受其管控的其他公司的注册商标。该商标受知识产权法律约束, SACMI 对该商标的使用符合适用的框架。Intel Core i7 商标仅具有描述性和解释性作用, 以真实且无误导的方式出现在本目录中, 并且不具有推广 SACMI 产品的目的。”